

## Chapter 19

Use with Section 3

## ENRICHMENT

## ● Seed Plants

## Mapping Gymnosperms and Angiosperms

## Materials

paper  
pencil

## Procedure

Choose an area with which you are familiar—a yard or a small park or the school grounds. Using a blank sheet of paper, make a map of the area that shows the major plants and identifies them as either gymnosperms or angiosperms. Make your map similar to the one below.

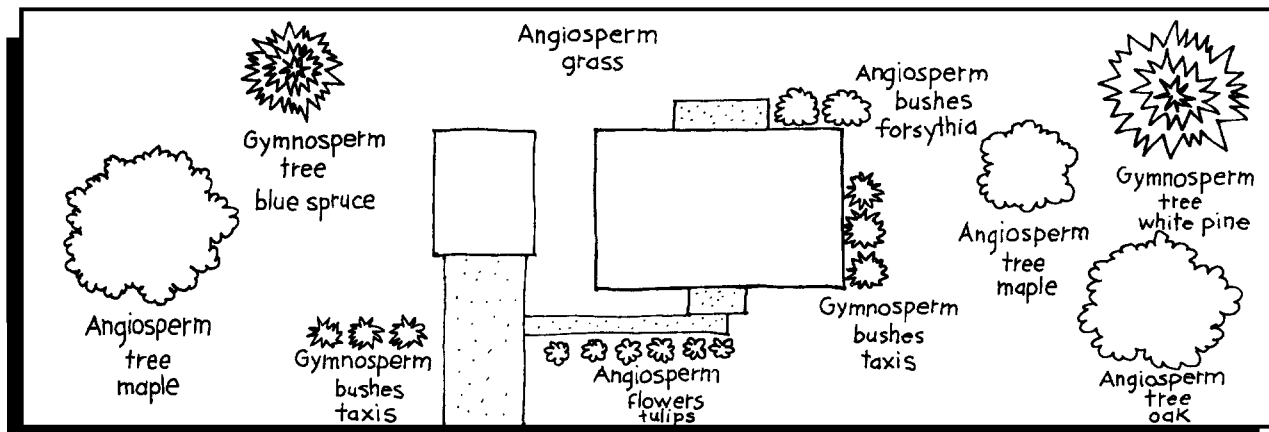

Identify the plants you map as specifically as you can. As shown on the example map, first write "Angiosperm" or "Gymnosperm." You may use information in your textbook to help you identify the plants as one or the other. Then, write a general term such as "tree," "bush," "flower," or "grass." Finally, write the specific name for any plants that you know. Ask adults for help. Many adults will be glad to tell you the names of the bushes and trees they have planted in their yards. Also, you can find books on tree and bush identification in almost any library.

## Conclude and Apply

1. Did you find more angiosperms or gymnosperms? \_\_\_\_\_

2. Of the angiosperms you identified, which are monocots and which are dicots? \_\_\_\_\_

3. What can you conclude about the variety of plants in an area? \_\_\_\_\_