

**Problem 139.** On a separate sheet of paper, duplicate the drawing and information below for practice in architectural design detailing and lettering.

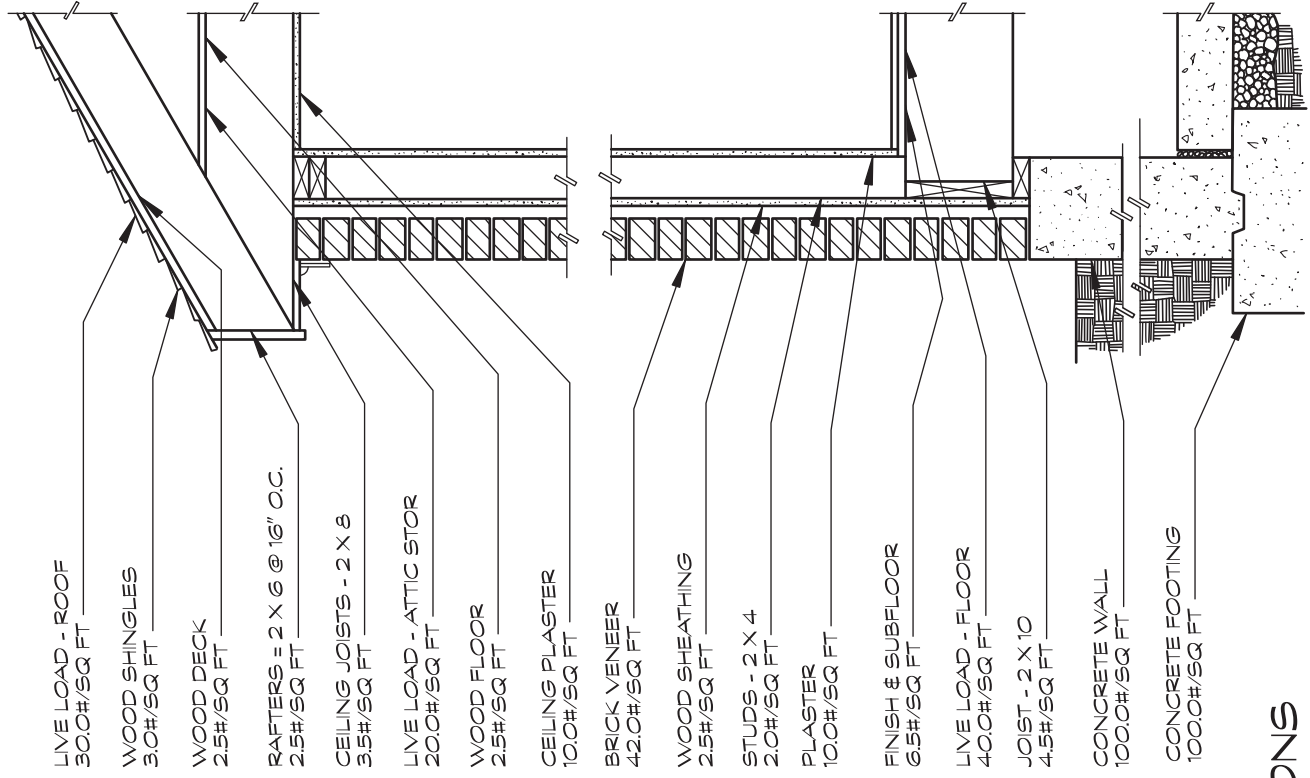

ROOF		
LIVE LOAD	30.0	
SHINGLES	3.0	
WOOD DECK	2.5	
RAFTER	2.5	
	<u>38.0 #/SQ FT X 13' = 494</u>	
CEILING		
LIVE LOAD	20.0	
WOOD FLOOR	2.5	
JOIST	3.5	
PLASTER	10.0	
	<u>36.0 #/SQ FT X 5' = 180</u>	
EXTERIOR WALL		
BRICK VENEER	42.0	
SHEATHING	2.5	
STUDS	2.0	
PLASTER	10.0	
	<u>56.5 #/SQ FT X 9' = 5055</u>	
FLOOR		
LIVE LOAD	40.0	
FINISH & SUB-FLOOR	6.5	
JOISTS	4.5	
	<u>38.0 #/SQ FT X 13' = 494</u>	
FOUNDATION		
CONCRETE WALL	100.0 #/SQ FT X 9' = 900	
CONCRETE FOOTING	100.0 #/SQ FT X 133' = 133	
		<u>25675# TOTAL</u>

$$A = \frac{P}{F} = \frac{25675}{2000 \text{ P.S.I.}} = 1.28375$$

## LOAD CALCULATIONS

SCALE: NONE