

CAD Problem 1

Pole Guide

Only the front and top views of a pole guide are shown below. Draw the front and top views and complete the upper right auxiliary view.

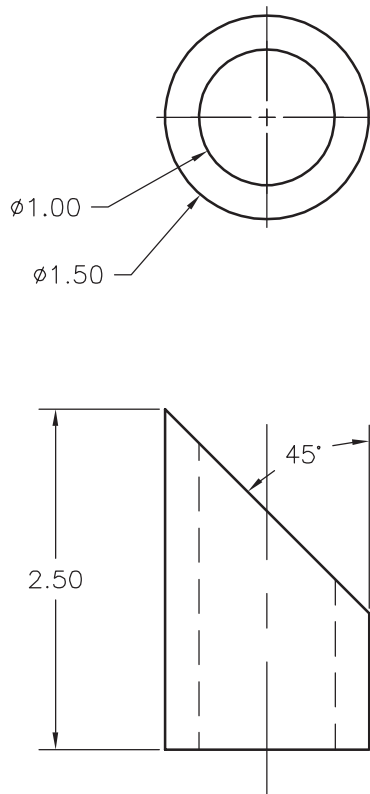

Autodesk Inventor® Users: Create a model of the pole guide. Then create a multiview drawing, complete with auxiliary view, to meet the problem requirements.

This problem can be used with the following Glencoe textbooks:

Textbook	Chapter
<i>Hands-On AutoCAD</i>	5
<i>Hands-On AutoCAD LT</i>	5
<i>Mechanical Drawing</i>	9
<i>Designing with Inventor 10</i>	9

CAD Problem 2

Auxiliary View

Only a top view is given for the object shown below. Draw the top and front views and complete the top, front, and upper right auxiliary views.

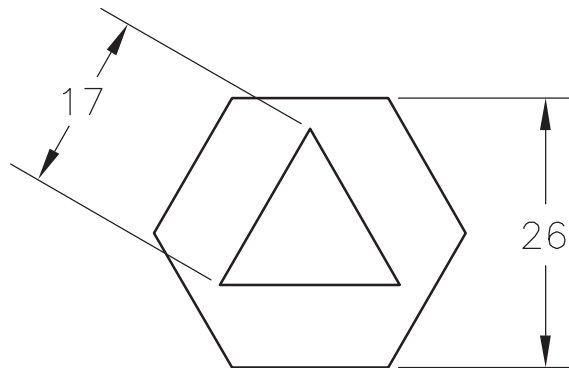

INCLINED SURFACE ANGLE: 30°
OVERALL HEIGHT: 50 mm

METRIC

Autodesk Inventor® Users: Create a model of the object. Then create a multiview drawing, including the auxiliary view, to meet the problem requirements.

This problem can be used with the following Glencoe textbooks:

Textbook	Chapter
<i>Hands-On AutoCAD</i>	5
<i>Hands-On AutoCAD LT</i>	5
<i>Mechanical Drawing</i>	9
<i>Designing with Inventor 10</i>	9

CAD Problem 3

Bracket

Create a multiview drawing using auxiliary views for the object shown below. Determine which views are appropriate. Estimate any dimensions that are not shown.

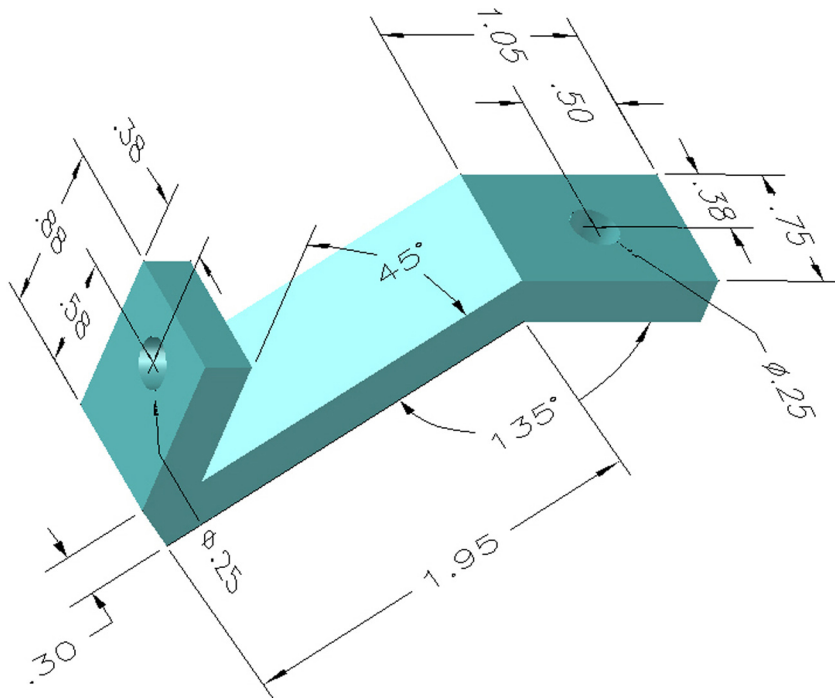

Autodesk Inventor® Users: Create a model of the bracket first. Then create a multiview drawing the required auxiliary views to meet the problem requirements.

This problem can be used with the following Glencoe textbooks:

Textbook	Chapter
<i>Hands-On AutoCAD</i>	5
<i>Hands-On AutoCAD LT</i>	5
<i>Mechanical Drawing</i>	9
<i>Designing with Inventor 10</i>	9



CAD Problem 4

True Length of a Line

Develop and calculate the true length of the line. The larger squares represent .50" and the smaller squares represent .125".

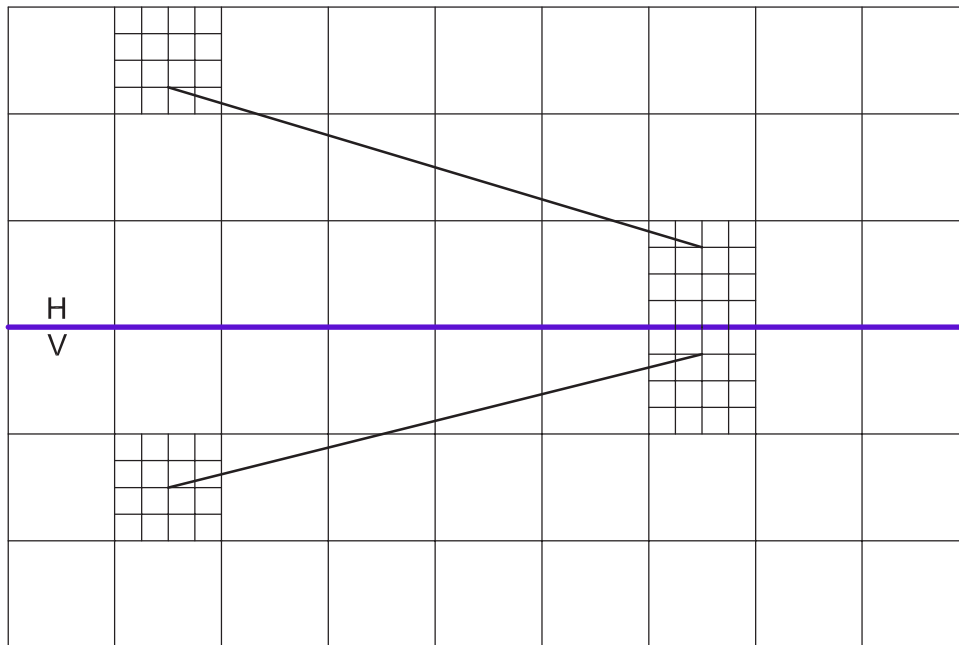

This problem can be used with the following Glencoe textbook:

Textbook	Chapter
<i>Mechanical Drawing</i>	10



CAD Problem 5

True Size of a Plane

Draw the true size of plane ABC. The larger squares represent .50" and the smaller squares represent .125".

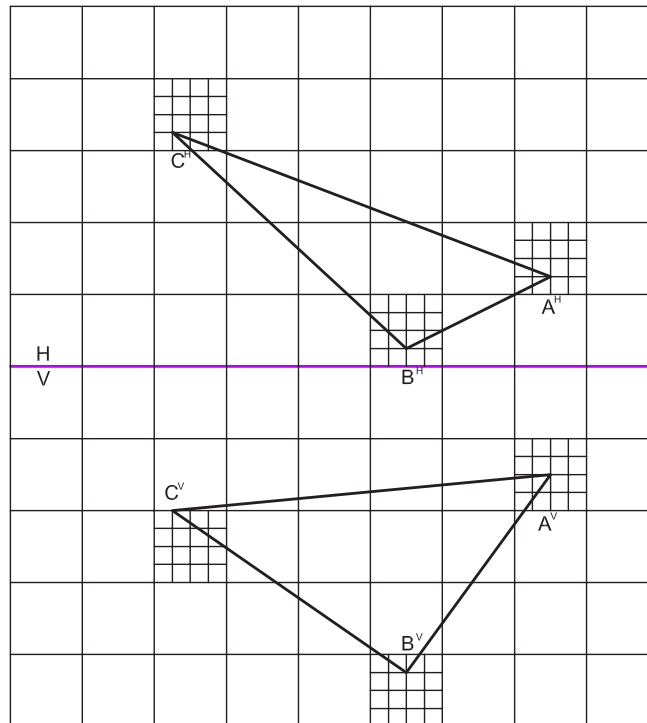

This problem can be used with the following Glencoe textbooks:

Textbook	Chapter
<i>Mechanical Drawing</i>	10